

Flight Procedures Cover Page	Task Action: FLIGHT CHECK	Task Type: Textual DP	Estimated Chart Date: 10/02/2025	APWS Task ID: 0B892662207244A2A6749152C50B9369	APWS Project ID: B71392FEC89A4E9988ECD3A7AC805862
Procedure: TAKEOFF MINIMUMS AND OBSTACLE DP AMDT 1A		Enroute: NO	Specialist: Palmer, Leo		Agreement Number:
Airport ID: E06			Airport City: LOVINGTON		State: NM
Facility ID:	Facility Type:	Flight Inspection Remark Type: New FC Slot			
<div>Procedure Comments:</div> <div>CLEAR NOTAM FDC 4/6935 - ADD/UPDATE TAKEOFF OBSTACLE NOTES. THERE ARE OBSTACLES THAT ARE EITHER CLOSER OR TALLER THAN THOSE PUBLISHED.</div> <div>UPDATED FORMS, FILES, AND PROCEDURE TO CURRENT CRITERIA.</div> <div>ACTIVE AIRPORT DATA USED: PUB'D 12/01/2022</div> <div>CONTACT DAVE DANNER (405)954-5077</div>					

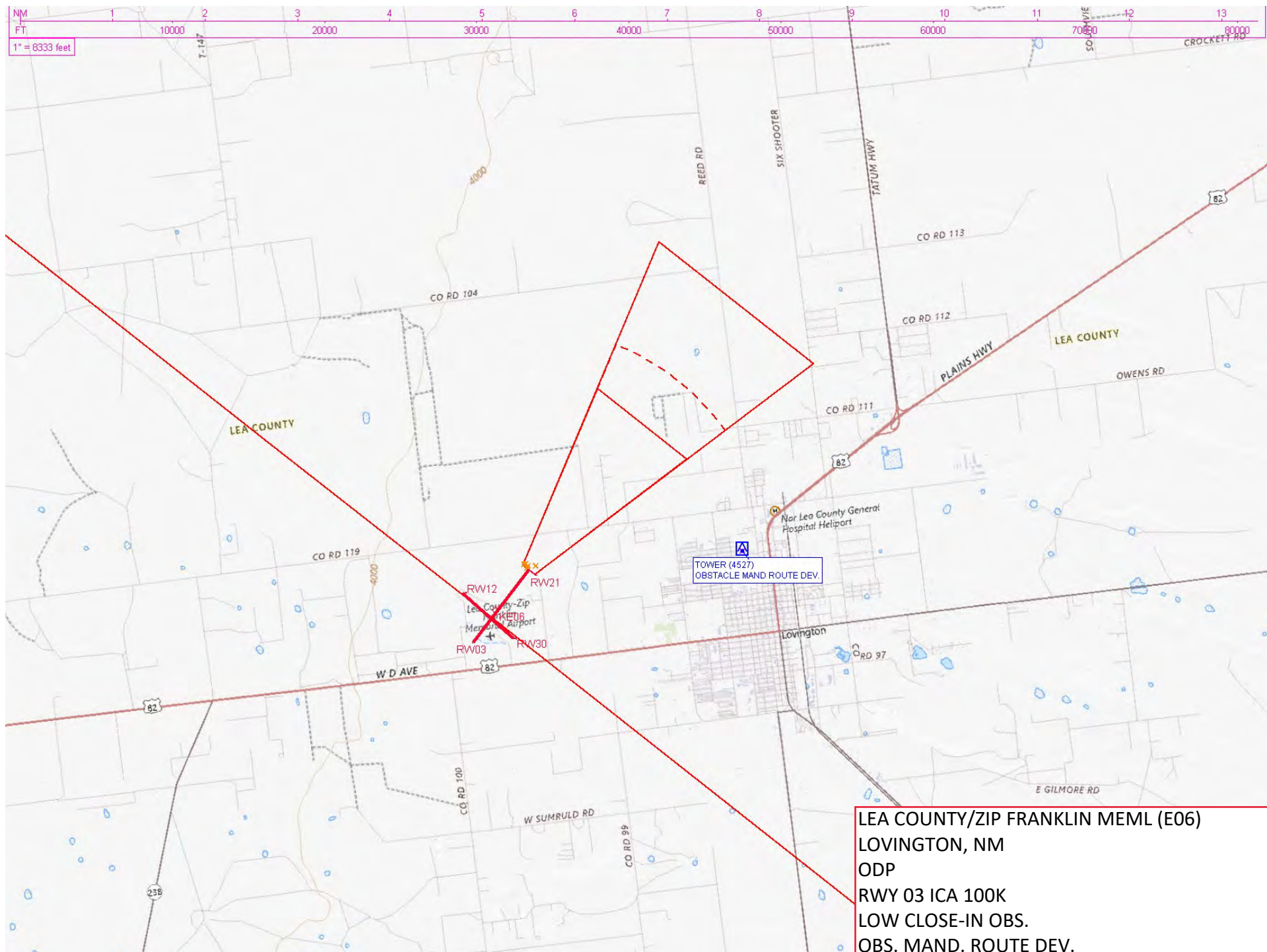

<b>FIPC BASIC FORM</b>							
<b>PROCEDURE:</b> TAKEOFF MINIMUMS AND OBSTACLE DP AMDT 1A			<b>AIRPORT NAME:</b> LEA COUNTY/ZIP FRANKLIN MEML		<b>AIRPORT ID:</b> KE06	<b>SPECIAL CONTROL NO:</b> OP-05-094-25	
<b>FAC ID:</b> KE06		<b>CITY:</b> LOVINGTON			<b>ST:</b> NM	<b>ORIG CHART DATE:</b> 10/02/2025	
<b>DFL TYPE:</b> PROC/T	<b>THIRD PARTY:</b> <input type="checkbox"/> YES	<b>EST. TIME ON SITE:</b> 0.4	<b>REIMB. NUMBER:</b>		<b>PTS TASK ID:</b> 0B892662207244A2A6749152C50B9369		
<b>PREFLIGHT NOTES</b>							
<b>REVIEWER:</b>					<b>DATE:</b>		
<b>COMMENTS:</b>					<b>CHECK ONE:</b>		
					<input type="checkbox"/> FLT CK REQ <input type="checkbox"/> NFCR <input type="checkbox"/> REJECT		
							<b>YES</b>
					<b>CPV COMPLETE?</b>		<b>X</b>
<b>PROCEDURE RESULTS</b>							
<b>INSPECTION DATE:</b> 05/31/2025		<b>CREW #:</b> VN564	<b>N #:</b> N89	<b>INSTRUMENT PROCEDURE STATUS:</b> <input checked="" type="checkbox"/> SAT <input type="checkbox"/> SAT W/CHANGES <input type="checkbox"/> UNSAT		<b>ARINC CODING:</b> <input type="checkbox"/> SAT <input type="checkbox"/> SAT/GOLD <input type="checkbox"/> UNSAT	
<b>FLIGHT INSPECTOR SIGNATURE:</b> eric w penney @ 05/31/2025 16:06			<b>PRINTED NAME:</b> PENNEY, ERIC WAYNE				<b>NOTAM INITIATED?</b> <input type="checkbox"/> YES <input checked="" type="checkbox"/> NO
<b>FLIGHT INSPECTOR REMARKS:</b> Special Number: OP-05-094-25 ODP, Amdt 1, Lovington, NM, completed satisfactory all runways.							
<b>IN-FLIGHT OBSTACLE REPORT</b>							
<b>OBSTRUCTION ID #:</b>	<b>COORDINATES OR LOCATION:</b>		<b>GNSS ALTITUDE (MSL):</b>		<b>BAROMETRIC ALTITUDE (MSL):</b>		<b>HEIGHT ABOVE GROUND LEVEL:</b>









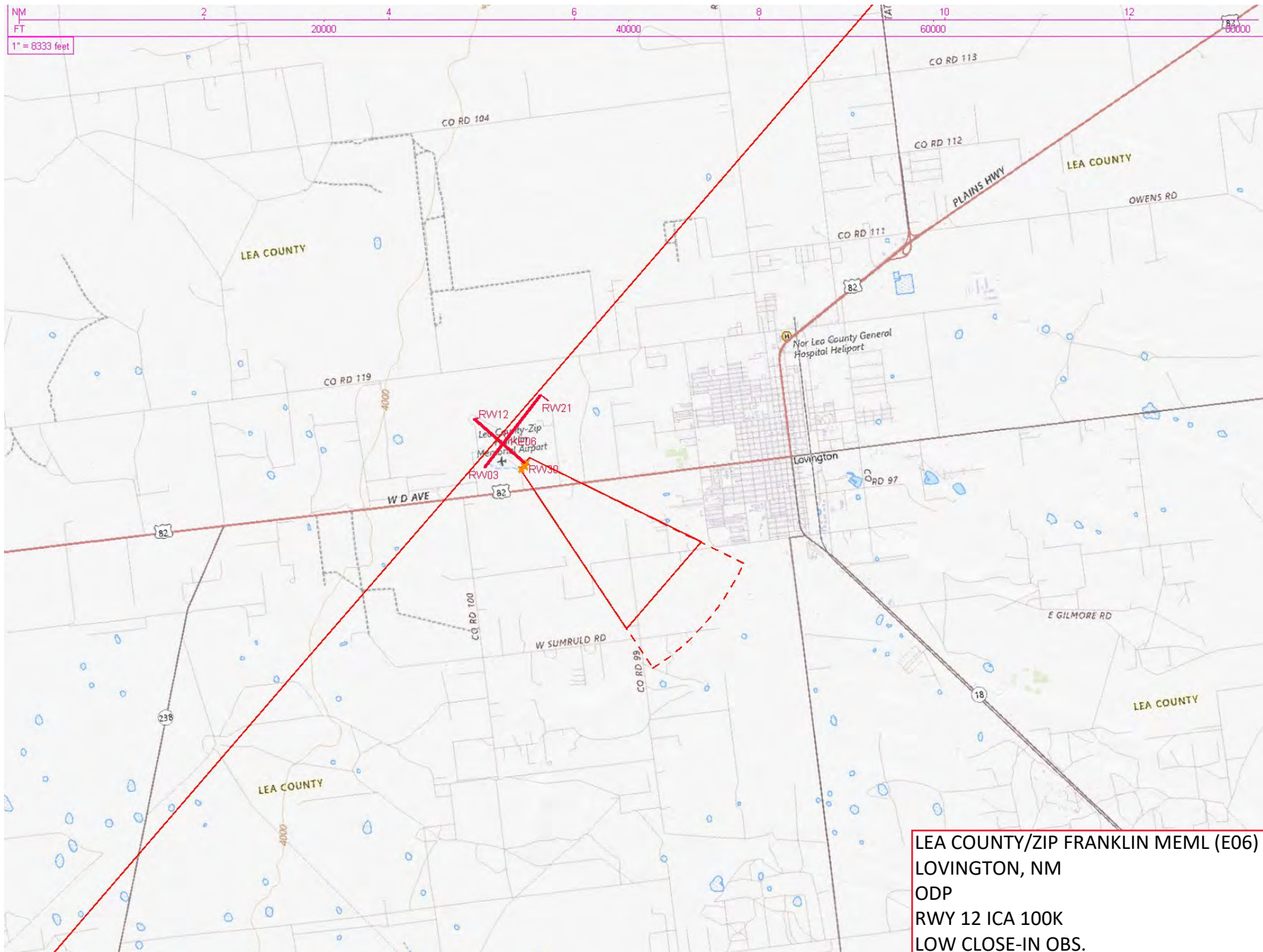



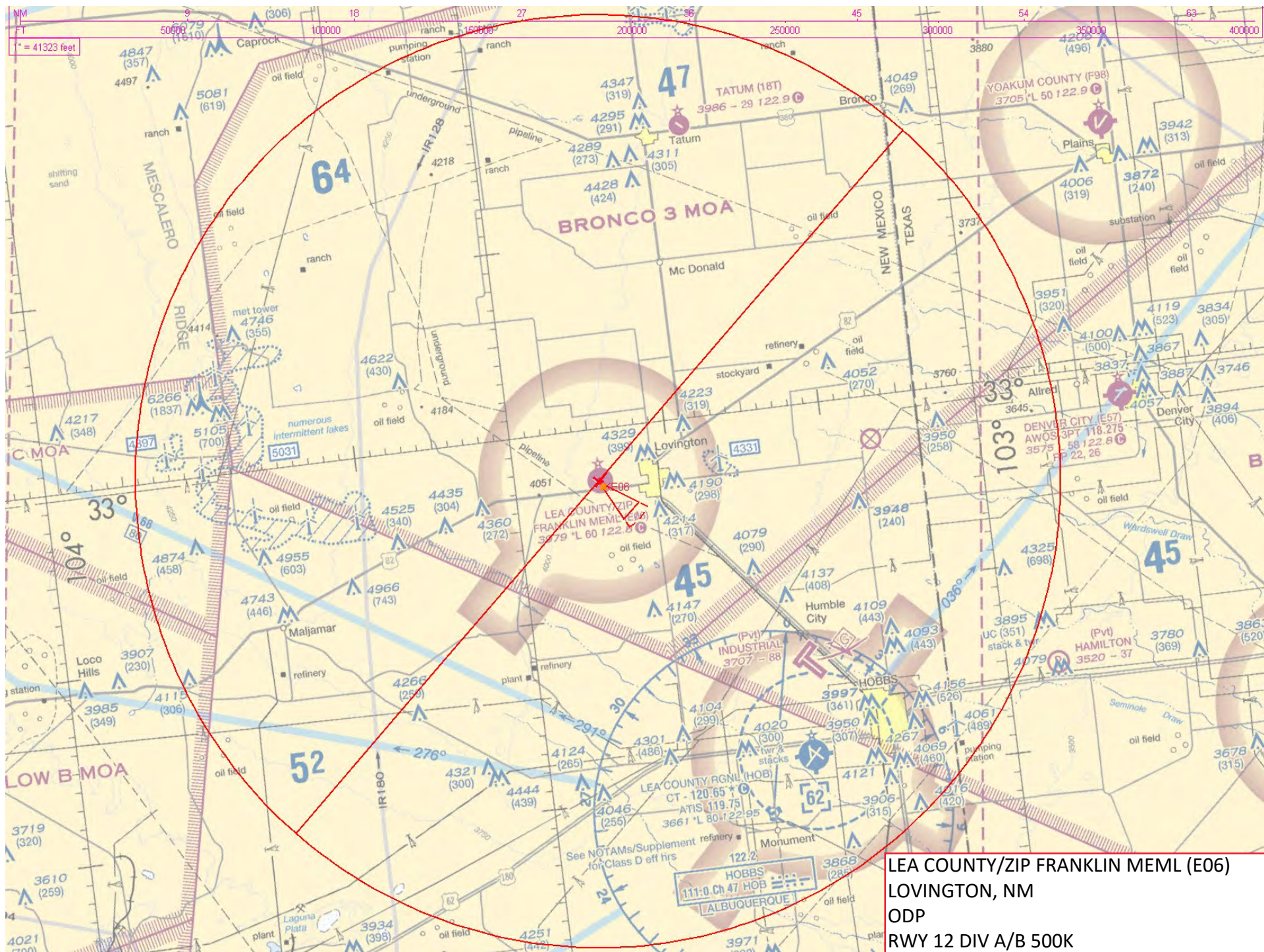



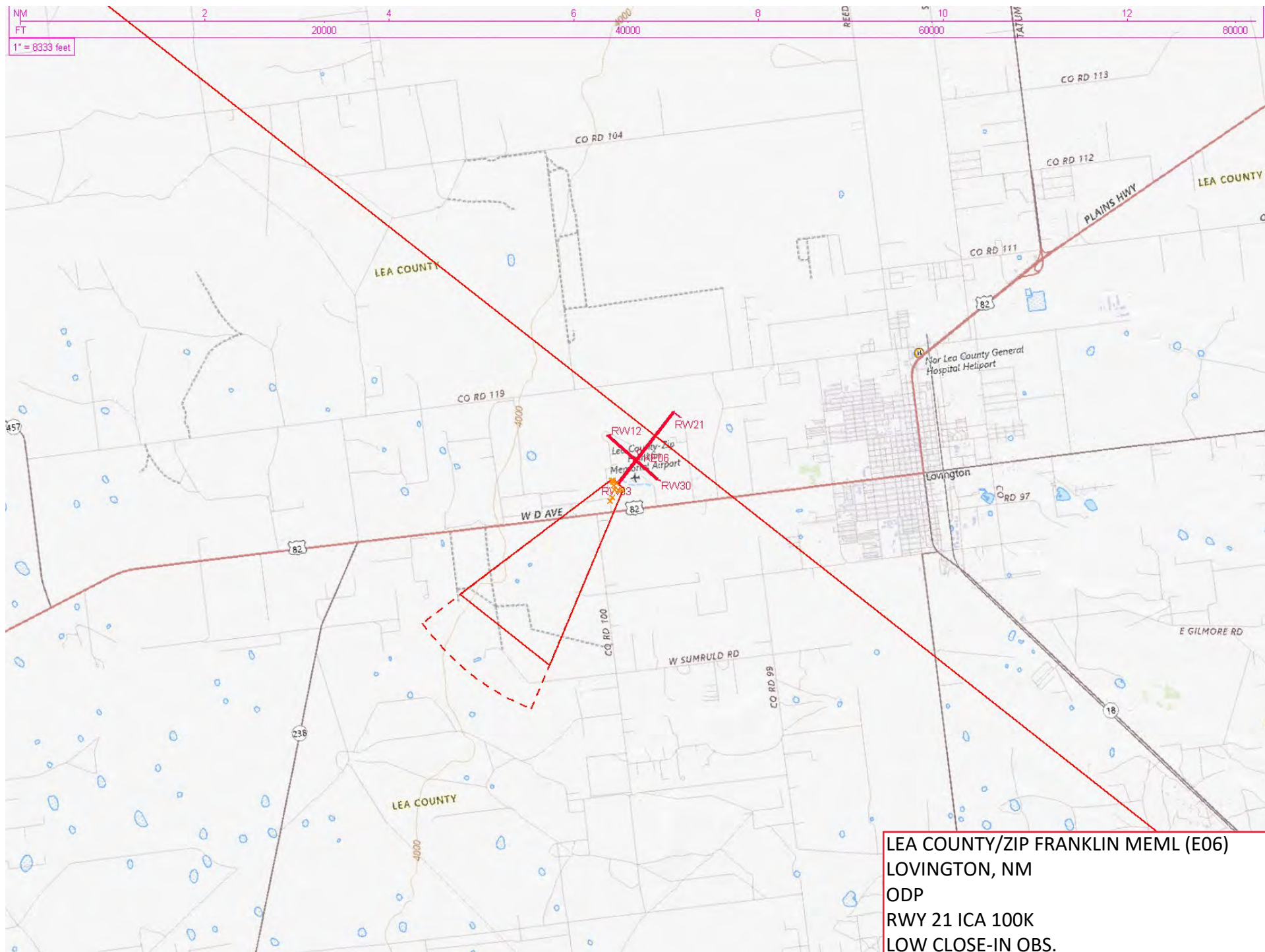



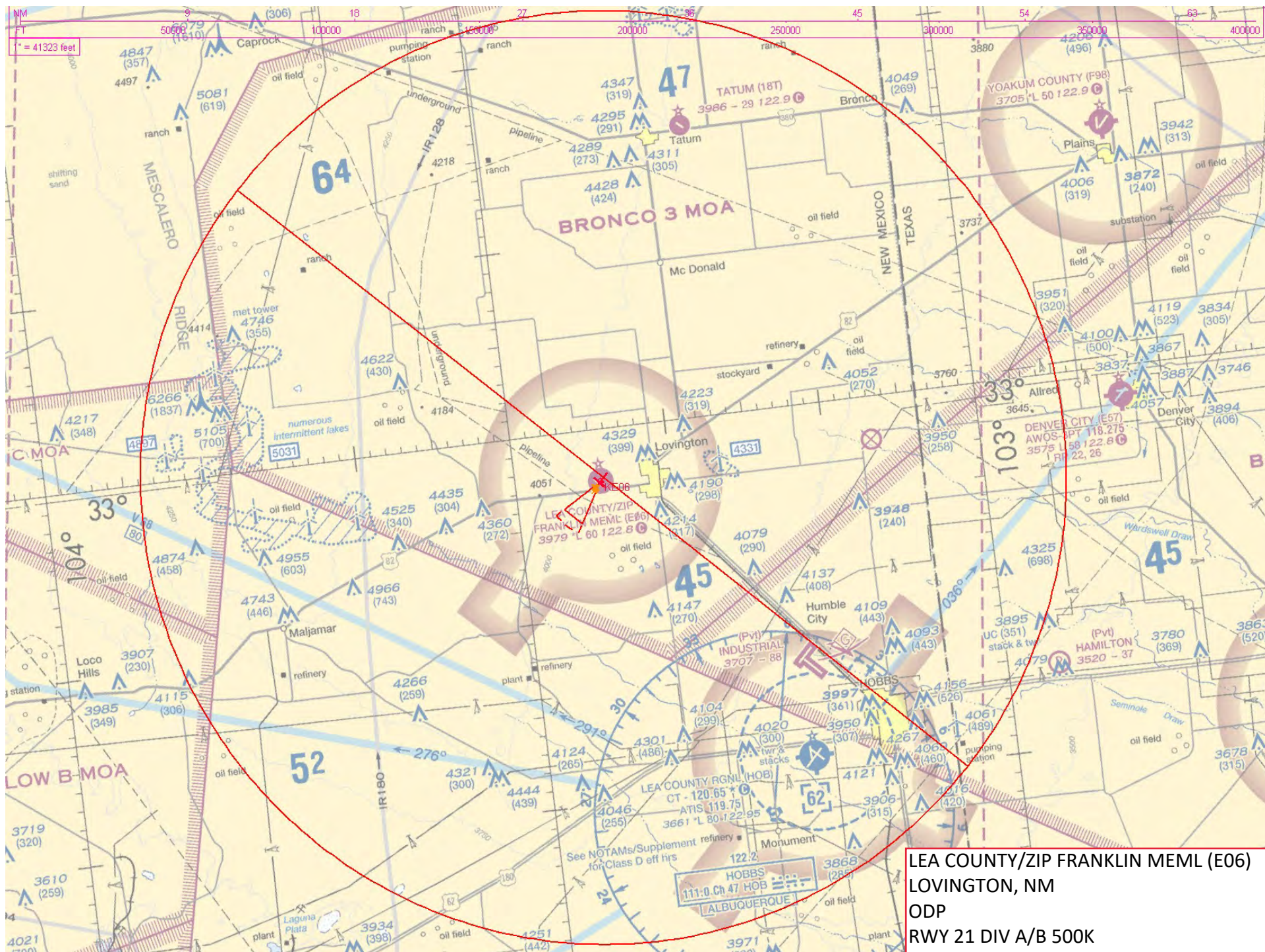



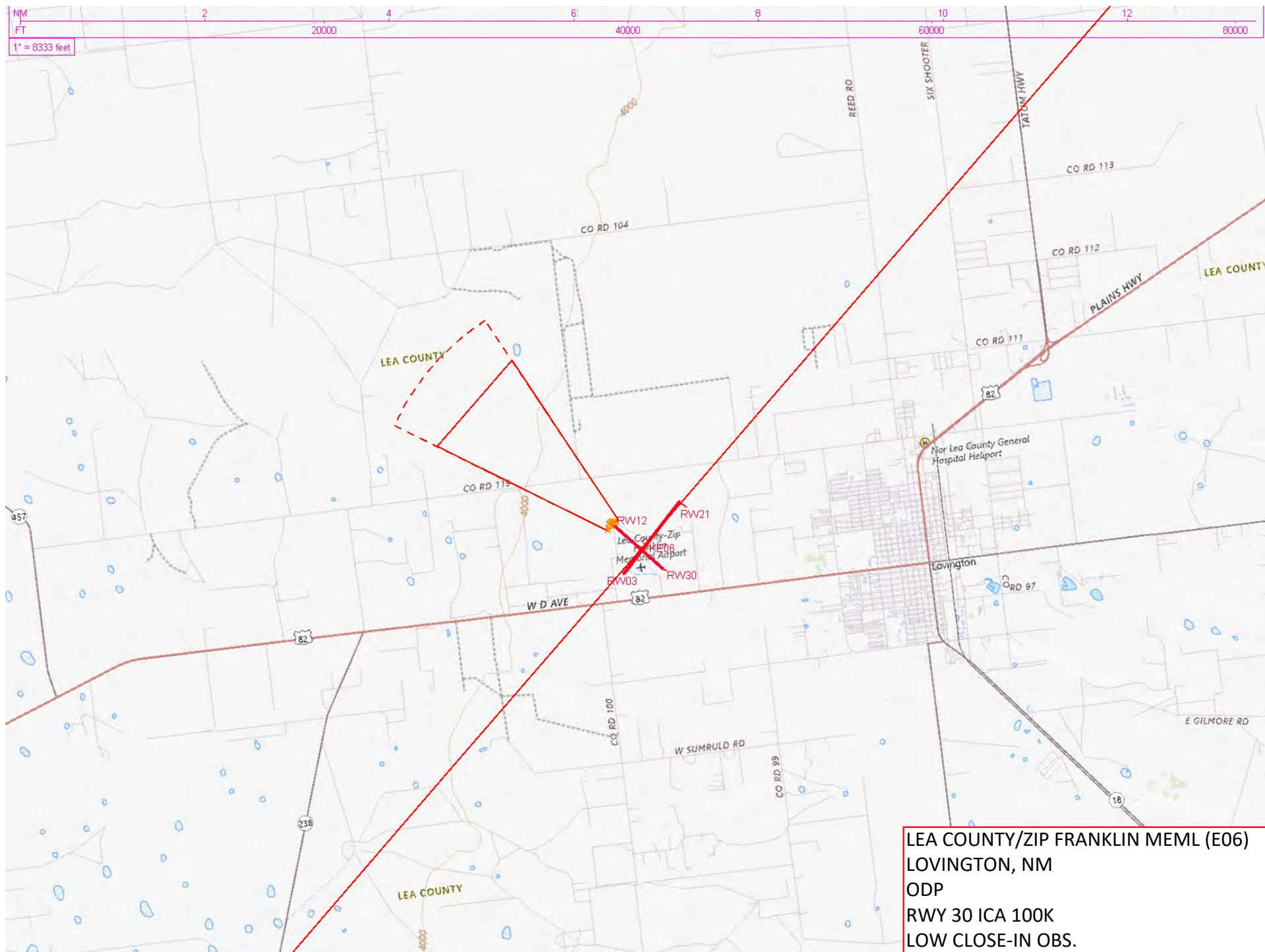



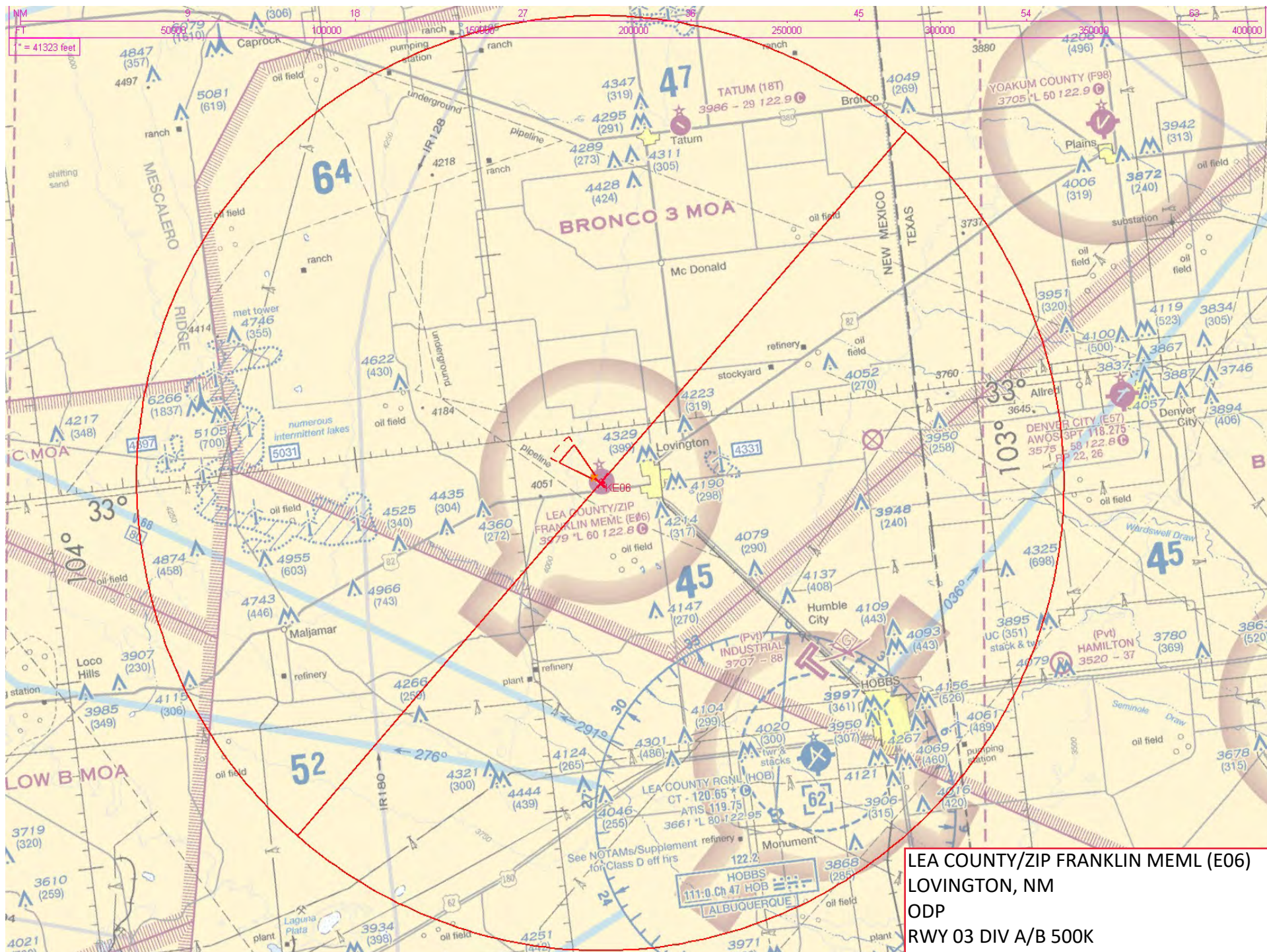

LEA COUNTY/ZIP FRANKLIN MEML (E06)  
LOVINGTON, NM  
ODP  
RWY 03 DIV A/B 500K



## LAS CRUCES, NM

### LAS CRUCES INTL

DEPARTURE PROCEDURE: **Rwys 4, 8**, climbing right turn. **Rwy 12**, CAT A,B, climb runway heading CAT C, D, NA. **Rwys 22, 26**, climbing left turn. **Rwy 30**, climbing runway heading to 5100 then climbing left turn.

**All aircraft** climb direct HAWKE LOM. Continue climb in HAWKE holding pattern (SE, left turns, 304° inbound) to cross HAWKE LOM at or above 10000 before proceeding on course.

## LAS VEGAS, NM

### LAS VEGAS MUNI

DEPARTURE PROCEDURE: **Rwys 2, 14** turn left/right. **Rwy 20**, turn left (except via FTIR-215). **Rwy 32**, turn right.

Departures via FTI VORTAC R-001 CW R-215 climb on course. Departures via FTI VORTAC R-216 CW R-360 proceed direct FTI VORTAC. Climb in FTI VORTAC holding pattern (hold north, left turn, 192° inbound) to cross FTI at airway MEA/MCA. (NOTE: climb in hold not authorized for turbojet aircraft)

## LEADVILLE, CO

### LAKE COUNTY (LXV)

#### AMDT 2 08101 (FAA)

DEPARTURE PROCEDURE: **Rwy 16**, use LOZUL (RNAV) DEPARTURE. **Rwy 34**, use DAVVY (RNAV) DEPARTURE.

## LONGMONT, CO

### VANCE BRAND

TAKE-OFF MINIMUMS: **Rwy 11**, 300-1 or std. with a min. climb of 250' per NM until passing 5400.

**Rwy 29**, CAT A,B 1900-3 or std. with a min. climb of 380' per NM until passing 7000. CAT C,D NA.

DEPARTURE PROCEDURE: Comply with RADAR vectors, or: **Rwys 11, 29**, turn right climb direct BJC VOR/DME. Departures on BJC R-340 CW R-150 climb on course. All others climb in BJC holding pattern (NE, left turns, 203° inbound) to cross BJC VOR/DME at or above 13300.

NOTE: Climb in holding NA for turbojet aircraft.

## LOS ALAMOS, NM

### LOS ALAMOS

TAKE-OFF MINIMUMS: **Rwy 27**, NA-obstacles and airport restriction.

DEPARTURE PROCEDURE: **Rwy 9**, climb via heading 092° until intercepting SAF VORTAC R-354. Northbound proceed via V83 climbing to 11000. Southbound proceed via V83 at 9000.

## LOVINGTON, NM

### LEA COUNTY-ZIP FRANKLIN MEMORIAL

DEPARTURE PROCEDURE: **Rwy 3**, climb runway heading to 4700 before turning on course. **Rwy 12**, 35' AGL powerline 1250' from departure end of runway 150' right of centerline. **Rwy 21**, 40' AGL tower 936' from departure end of runway 273' right of centerline. **Rwy 30**, 50' AGL windmill 1800' from departure end of runway 50' right of centerline.

## MEEKER, CO

### MEEKER (EEO)

#### AMDT 1 08157

TAKE-OFF MINIMUMS: **Rwys 3, 21**, 4100-3 for climb in visual conditions.

DEPARTURE PROCEDURE: **Rwys 3, 21**, for climb in visual conditions: cross Meeker Airport at or above 10500 before proceeding on course.

NOTE: **Rwy 21**, multiple trees beginning 843' from departure end of runway, 20' left of centerline, up to 100' AGL/7190' MSL. Multiple trees beginning 227' from departure end of runway, 187' right of centerline, up to 100' AGL/6862' MSL.

## MONTE VISTA, CO

### MONTE VISTA MUNI

DEPARTURE PROCEDURE: **Rwy 2**, climbing right turn.

**Rwy 20**, climbing left turn. **All aircraft**, climb direct ALS VORTAC, continue climb in ALS holding pattern (SE, right turns, 301° inbound) to cross ALS VORTAC at or above 11,000, except V210 westbound 11,200 and J102 northeastbound 13,700, before proceeding enroute.

## MONTROSE, CO

### MONTROSE RGNL (MTJ)

#### AMDT 4 09127 (FAA)

DEPARTURE PROCEDURE: Use MONTROSE DEPARTURE.

## NUCLA, CO

### HOPKINS FIELD

TAKE-OFF MINIMUMS: **Rwys 11, 29**, NA-environmental DEPARTURE PROCEDURE: **Rwys 5, 23**, use NUCLA (RNAV) DEPARTURE.

## PAGOSA SPRINGS, CO

### STEVENS FIELD (PSO)

#### ORIG 08045 (FAA)

TAKE-OFF MINIMUMS: **Rwy 1**, std. w/ min. climb of 437' per NM to 9600, or 1900-3 for climb in visual conditions.

**Rwy 19**, std. w/ min. climb of 296' per NM to 9300, or 1900-3 for climb in visual conditions.

DEPARTURE PROCEDURE: **Rwy 1**, climbing right turn via heading 216° to intercept DRO VOR/DME R-066 to DRO VOR/DME .... for climb in visual conditions cross Stevens Field airport south bound at or above 9400 MSL, then via DRO VOR/DME R-066 to DRO VOR/DME ....

**Rwy 19**, climb via heading 194° to intercept DRO VOR/DME R-075 to DRO VOR/DME .... for climb in visual conditions cross Stevens Field airport south bound at or above 9400 MSL, then via DRO VOR/DME R-066 to DRO VOR/DME ....

... thence cross DRO VOR/DME at MEA/MCA for direction of flight before proceeding on course.

NOTE: **Rwy 1**, terrain beginning 30' from departure end of runway, 53' left of centerline, up to 7697' MSL. Terrain beginning 127' from departure end of runway, 69' right of centerline, up to 7681' MSL. Multiple trees beginning 940' from departure end of runway, left and right of centerline, up to 100' AGL/7739' MSL. **Rwy 19**, multiple trees beginning 664' from departure end of runway, 156' left of centerline, up to 100' AGL/7693' MSL. Multiple trees beginning 1625' from departure end of runway, 5' right of centerline, up to 100' AGL/7698' MSL.

# Periodic Review

Robert W. Cook

02-18-22

LEA COUNTY-ZIP FRANKLIN MEMORIAL AIRPORT  
LOVINGTON, NM (KE06)

TAKEOFF MINIMUMS AMDT 1

Review Type: FULL

## Summary/Findings

TAKEOFF MINIMUMS/OBSTACLE DEPARTURE PROCEDURE (T-O-M/ODP)  
PERIODIC REVIEW (PR)

DATE: 02/18/2022 DUE DATE: 02/28/2022 ASSMNT: FULL.

CENTRAL SERVICE AREA (CSA) POC: thomas.inkman@faa.gov

APT NAME/ICAO ID, CITY/STATE: LEA COUNTY-ZIP FRANKLIN MEMORIAL  
AIRPORT (KE06) LOVINGTON, NM.

OWNERSHIP: PUBLIC. OWNER: LEA COUNTY ADDRESS: PO BOX 1106  
HOBBS, NM 88241-1106 PHONE NR: 575-391-2934 MANAGER:  
COREY NEEDHAM ADDRESS: PO BOX 1106 HOBBS, NM 88241-1106 PHONE  
NR: 575-391-2934.

DOES NASR, AIRNAV AND FAA 5010 AIRPORT NAME DATA ALL MATCH:  
YES.

T-O-M/ODP AMDT 1 30DEC99 TYPE: STANDARD.

### SUMMARY/FINDINGS

DOES THIS PCDR STILL EXSIST/FAA MAINTAINED: YES. IS THERE A  
CONTINUED NEED FOR THIS PCDR: YES.

IS THERE AN APWS PROJECT TO AMEND/CANCEL THIS PCDR: NO.

DOES AIRNAV OIS DATA SOURCE SUPPORT THIS IAP: YES.

DOES KHOB AWOS-3 119.75 (575) 393-8418 (FULL TIME REMOTE WEATHER  
SOURCE) REPORT TO WMSCR, VERIFIED AND DOCUMENTED IN AIRNAV:  
YES, THERE IS NO WEATHER REPORTING AVAILABLE AT KE06.

ANY CHART SUPPLEMENT COMMENTS THAT COULD EFFECT SAFETY OF  
FLIGHT OF THIS PCDR: NO.

ANY NAVAID(S) OR FLIGHT INSPECTION RESTRICTION(S) IMPACTING THIS  
PCDR: NO.



ANY FDC OR "D" NOTAM(S) EFFECTING THIS PCDR: NO. ARE THERE ANY  
NEW NOTAMS REQUIRED FOR THIS PCDR: NO.  
ARE THERE FAA 8260 FORMS IN THE DIGITAL "F" FILE: YES. DOES THE  
PUBLISHED TPP MATCH THE FAA 8260 FORMS: YES.  
ARE THERE FLIGHT INSPECTION MAPS (FIMS) IN THE DIGITAL "S" FILE:  
YES. DO THE FIMS MATCH THE PCDR: YES.  
ANY ACTIVE WAIVER(S)/AFS APPROVAL LETTER(S) IN DIGITAL "S" FILE:  
NO.  
ARE THE CURRENT PUBLISHED MINIMUMS VALID: YES.  
AIRPORT AND NAVAID MAGVAR TABLES ARE MAINTAINED BY  
AERONAUTICAL INFORMATION SERVICES AND PROVIDED TO THE  
OSG-FPT OFFICES FOR WORK SCHEDULING AT THEIR DISCRETION.  
REMARK(S): APPLY CURRENT CRITERIA AND DOCUMENTATION  
STANDARDS WITH NEXT AMDT.

## Actions/Notes

# Periodic Review

John R. Thornton

02-19-20

LEA COUNTY-ZIP FRANKLIN MEMORIAL AIRPORT  
LOVINGTON, NM (KE06)

TAKEOFF MINIMUMS AMDT 1

Review Type: PARTIAL

## Summary/Findings

1. FULL ASSESSMENT COMPLETED.
  2. MAG VAR WITHIN TOLERANCE: 7E/2015 IN USE; 7E/2020 FORECAST.
  3. NOTAM REQUIRED: NO.
  4. AMENDMENT REQUIRED: NO.
- ADDITIONAL INFORMATION:
1. UPDATE TAKEOFF OBSTACLE NOTES DURING NEXT FULL AMENDMENT.
  2. UPDATE FORMS/DOCUMENTATION TO CURRENT CRITERIA DURING NEXT FULL AMENDMENT.

## Actions/Notes

SAFE AS PUBLISHED.



# Periodic Review

Phillip Brandenburg

03-06-18

LEA COUNTY-ZIP FRANKLIN MEMORIAL AIRPORT  
LOVINGTON, NM (KE06)

TAKEOFF MINIMUMS

## Summary/Findings

Full review complete. NOTAM and amdt not req.

## Actions/Notes

<b>Flight Procedure Tracking Form</b>			<b>Action:</b> REVIEW/INQUIRY	<b>Task Type:</b> BRO	<b>Date Open:</b> 04/04/2013	<b>Task #:</b> 2013040416884201001	<b>Request #:</b> 20130404168842
<b>Procedure:</b> TAKE-OFF MINIMUMS				<b>Airport ID:</b> KE06	<b>Airport:</b> LEA COUNTY-ZIP FRANKLIN MEMORIAL		<b>Reimbursable #:</b>
<b>City:</b> ST: NM			<b>GPS #:</b>		<b>Estimated Chart Date:</b> 09/26/2013		<b>FICO #:</b>
<b>Fac ID:</b>		<b>Fac. Type:</b>		<b>Specialist:</b> DONALD LANIER			
<b>Procedure Review</b>							
	<b>Rec'd</b>	<b>Rel'd</b>	<b>Full Name</b>	<b>Comments</b>			
<b>Lead:</b>							
<b>QA:</b>							
<b>Liaison:</b>							
<b>Procedure Comments:</b>				<b>Remark Type:</b> INFORMATION			
<p>AIRPORT NAME &amp; ID: LEA COUNTY-ZIP FRANKLIN MEMORIAL, LOVINGTON, NM (KE06).  TAKEOFF MINIMUMS AND OBSTACLE DEPARTURE PROCEDURES, AMDT 1.  BIENNIAL REVIEW FINDINGS 9/26/13. RUNWAY 3: MAY CONSIDER REMOVING DEPARTURE PROCEDURE SINCE 4527 MSL NO LONGER IN DATABASE AND APPEARS TO HAVE BEEN REMOVED (OLD GOOGLE EARTH STILLS SHOWS A TOWER IN CLOSE PROXIMITY-VERIFY DISMANTLED). ALL RUNWAYS STANDARD TAKEOFF MINIMUMS GOOD. NO NEW OBSTACLES CAUSE ANY PROCEDURE UPDATES, EXCEPT CAN UPDATE LOW CLOSE-IN OBSTACLES FOR ALL RUNWAYS. FORMS NEED TO BE UPDATED. PROCEDURE SAFE AS PUBLISHED. AMENDMENT REQUIRED.</p>							



CONCURRENCES
ROUTING SYMBOL
AVN-130
INITIALS/SIG
PDA
DATE
7/22/99
ROUTING SYMBOL
AVN-130
INITIALS/SIG
SPECIALIST
DATE
SN 7/22/99
ROUTING SYMBOL
AVN-130
INITIALS/SIG
LEAD E
DATE
7-23-99
ROUTING SYMBOL
AVN-160
INITIALS/SIG
QC
DATE
7/23/99
ROUTING SYMBOL
INITIALS/SIG
DATE
ROUTING SYMBOL
INITIALS/SIG
DATE
ROUTING SYMBOL
INITIALS/SIG
DATE

Subject: **ACTION**: Transmittal of Data

Date: JUL 26 1999

From: Manager, South Central & Alaska Flight  
Procedures Development Branch, AVN-130

Reply to L. Nugent  
Attn. of: (405)954-9422  
FAX (405)954-1329

To: Manager, National Flight Data Center, ATA-110

We are submitting the following FAA forms for Lea County-Zip Franklin Memorial, Lovington, New Mexico for publication:

8260-3 GPS RWY 21, AMDT 1    8260-3 GPS RWY 03, AMDT 1  
8260-15A TAKEOFF MINIMUMS & TEXTUAL DEPARTURE  
8260-2 ARHIF, ORIG                      8260-2 TATAW, REV 1  
8260-2 ABIZY, REV 1                      8260-2 PICTA, REV 1  
8260-2 HOBBS VORTAC, REV 6

Also we are submitting the following forms for cancellation and request these names be reserved for AVN-130 for use at a later date:

8260-5 VOR/DME RNAV RWY 3, ORIG  
8260-2 HAFNU, ORIG                      8260-2 BOXBU, ORIG  
8260-2 RALFH, ORIG                      8260-2 MIDCO, ORIG

Rick A. Webb

Attachments

cc: AVN-100rf/AVN-130rf/ZFW/FTW FPO/AVN-250/AMGR/  
ST AV DIR/ALPA/AOPA/NBAA

File: Lea County/Zip Franklin, Lovington, NM



# FLIGHT PROCEDURES CONTROL

CONTROL NUMBER

99008420

PROJECT:

LEA-COUNTY-ZIP FRANKLIN MEMORIAL, LOVINGTON, NM

7784

DATE CLOSED:

NAME:

DEPARTURE PROCEDURE, AMDT 1

SUSPENSE DATE:

RECEIVED FROM:

LOCAL

DATE:

04/22/99

MAPS USED ☐

ASSIGNED TO:

LORRAINE NUGENT

DATE:

NO MAPS USED ☒

## List of Maps Used

## Procedure Development

PROCEDURE STUDY BY:

LORRAINE NUGENT

DATE:

05/03/99

REVIEWED BY:

DATE:

5-4-99

## Quality Control

NAME:

Duffy

See my sticker

DATE IN

DATE OUT

6/5/99

NAME:

DATE IN

DATE OUT

NAME:

DATE IN

DATE OUT

NAME:

DATE IN

DATE OUT

## Flight Check Dates

ASSIGNED:

RETURNED:

FLIGHT CHECKED BY:

DATE:

REMARKS:

Flight Check not required  
per Rick Webb, AVM-130 Mgr





# FLIGHT PROCEDURES CONTROL

PROJECT:

LEA-COUNTY-ZIP FRANKLIN MEMORIAL, LOVINGTON, NM

CONTROL NUMBER

NAME:

DEPARTURE PROCEDURE, AMDT 1

REMARKS:

# Periodic Review

Jay D. Baggett

03-13-24

LEA COUNTY-ZIP FRANKLIN MEMORIAL AIRPORT  
LOVINGTON, NM (KE06)

TAKEOFF MINIMUMS AMDT 1

Review Type Required: PARTIAL

PR completed due to:

## Summary/Findings

1. Airport name, Location, and ID correct: YES,
2. IFP Name & AMDT # correct: YES, MATCHES FORMS.
3. PR completed: PARTIAL.
4. Current forms are in Active Procedure Folder: YES,
5. TPP chart accurately reflects 8260 source documents: YES,
6. Are waivers on 8260 source documents active: N.A.
7. Verified all active NOTAMs are Valid and have current AMDT #: YES,
8. If a legacy IFP, checked for NavAid NTMs & restrictions that impact IFP: YES,
9. Verified AIRNAV data supports IFP as published: YES,
10. Was APR used and, if so, provide validation results: NO.

Validation Details:

11. NOTAM & Amendment Required: YES.
12. MAGVAR status: Airport and NavAid MagVar tables are maintained by Aeronautical Information Services and provided to the OSG-FPT offices for work scheduling at their discretion.
13. Non safety-related items will be resolved during next amendment: UPDATE FORMS AND BRING PROCEDURE UP TO CURRENT STANDARDS AT NEXT AMENDMENT.
14. Other pertinent findings: TAKEOFF OBSTACLE NOTES UPDATED VIA NOTAM.

!FDC 4/6935 E06 ODP LEA COUNTY/ZIP FRANKLIN MEML, LOVINGTON, NM. TAKEOFF MINIMUMS AND (OBSTACLE) DEPARTURE PROCEDURES AMDT 1... TAKEOFF OBSTACLE NOTES: RWY 3, VEGETATION 14 FT



FROM DER, 163 FT LEFT OF CENTERLINE, 3973 FT MSL. VEGETATIONS BEGINNING 67 FT FROM DER, 224 FT LEFT OF CENTERLINE, UP TO 3981 FT MSL. VEGETATION 474 FT FROM DER, 161 FT RIGHT OF CENTERLINE, 3979 FT MSL. RWY 12, TRAVERSE WAY, VEGETATION BEGINNING 43 FT FROM DER, 180 FT RIGHT OF CENTERLINE, UP TO 3986 FT MSL. POLE, TRANSMISSION LINE, VEGETATIONS, TRAVERSE WAY BEGINNING 108 FT FROM DER, 131 FT RIGHT OF CENTERLINE, UP TO 4001 FT MSL. VEGETATION 122 FT FROM DER, 123 FT LEFT OF CENTERLINE, 3975 FT MSL. RWY 21, FENCE, TERRAIN BEGINNING 5 FT FROM DER, 97 FT RIGHT OF CENTERLINE, UP TO 2 FT AGL/3980 FT MSL. VEGETATION 71 FT FROM DER, 466 FT RIGHT OF CENTERLINE, 3982 FT MSL. VEGETATION 102 FT FROM DER, 331 FT RIGHT OF CENTERLINE, 3984 FT MSL. TRAVERSE WAYS BEGINNING 158 FT FROM DER, 323 FT LEFT OF CENTERLINE, UP TO 3991 FT MSL. TRAVERSE WAY 223 FT FROM DER, 156 FT RIGHT OF CENTERLINE, 3992 FT MSL. TRAVERSE WAY 450 FT FROM DER, 81 FT LEFT OF CENTERLINE, 3992 FT MSL. TRANSMISSION LINE, POLE BEGINNING 949 FT FROM DER, 275 FT LEFT OF CENTERLINE, UP TO 38 FT AGL/4014 FT MSL. POLE 1221 FT FROM DER, 281 FT LEFT OF CENTERLINE, 39 FT AGL/4015 FT MSL. RWY 30, SIGN 14 FT FROM DER, 123 FT LEFT OF CENTERLINE, 3 FT AGL/3982 FT MSL. VEGETATION 24 FT FROM DER, 142 FT RIGHT OF CENTERLINE, 3984 FT MSL. VEGETATIONS BEGINNING 39 FT FROM DER, 119 FT RIGHT OF CENTERLINE, UP TO 3987 FT MSL. VEGETATION 58 FT FROM DER, 473 FT LEFT OF CENTERLINE, 3986 FT MSL. VEGETATION 121 FT FROM DER, 168 FT RIGHT OF CENTERLINE, 3989 FT MSL. TRAVERSE WAYS BEGINNING 143 FT FROM DER, 120 FT LEFT OF CENTERLINE, UP TO 3996 FT MSL. TRAVERSE WAYS BEGINNING 166 FT FROM DER, 131 FT RIGHT OF CENTERLINE, UP TO 3995 FT MSL. TRAVERSE WAY 275 FT FROM DER, 13 FT RIGHT OF CENTERLINE, 3996 FT MSL. ALL OTHER DATA REMAINS AS PUBLISHED. 2403132006-2603132006EST

## Actions/Notes

NOTAM ISSUED.