

(OOM5.OOM) 23334

# HOOSIER FIVE DEPARTURE

AL-5438 (FAA)

INDIANAPOLIS EXEC (TYQ)  
INDIANAPOLIS, INDIANA

AWOS-3PT  
120.725  
INDIANAPOLIS DEP CON  
124.65 127.15 317.8

**TOP ALTITUDE:  
ASSIGNED BY ATC**

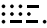
BRICKYARD  
116.3 VHP   
Chan 110

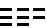
HOOSIER  
110.2 OOM   
Chan 39

POCKET CITY  
113.3 PXV   
Chan 80

TAKEOFF MINIMUMS:  
Rwys 18, 36: Standard.

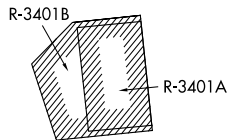
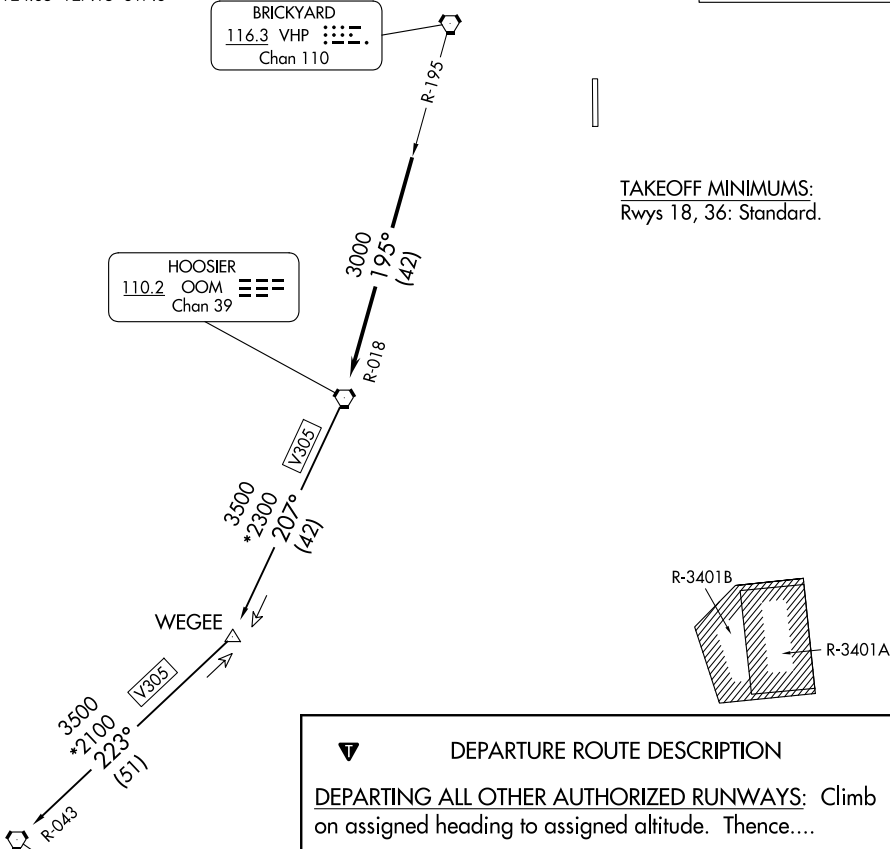

## DEPARTURE ROUTE DESCRIPTION

DEPARTING ALL OTHER AUTHORIZED RUNWAYS: Climb on assigned heading to assigned altitude. Thence....

....expect RADAR vectors to join VHP R-195 to OOM VORTAC then via transition or assigned route. Expect clearance to requested altitude ten minutes after departure.

POCKET CITY TRANSITION (OOM5.PXV): From over OOM VORTAC via OOM R-207 to WEGEE, then via PXV R-043 to PXV VORTAC.

- NOTE: RADAR required.
- NOTE: Select appropriate localizer/DME frequency/channel prior to departure.
- NOTE: Turbojets accelerate to 250K until reaching 10000, if unable advise ATC.
- NOTE: Assigned to aircraft with a requested altitude of 11000 or above.

NOTE: Chart not to scale.

EC-2, 11 JUN 2026 to 09 JUL 2026

EC-2, 11 JUN 2026 to 09 JUL 2026

# HOOSIER FIVE DEPARTURE

(OOM5.OOM) 01FEB18

INDIANAPOLIS, INDIANA  
INDIANAPOLIS EXEC (TYQ)